



### Genuine Renewal Parts

- **CONTROL STOPS**
- **NO. 50 VACUUM BREAKERS**
- **NUTS & FLANGES**
- **FLUSH CONNECTIONS**

## RENEWAL PARTS & SERVICE FOLDER

Revised 1-Oct-'17

Replaces folder SVB-2, dated 4-11-80

*Prices in this folder are subject to change without notice and supersede all previous prices. It is not to be construed that possession of this price folder by any person is an offer to sell him, or anyone else, the material listed herein at the prices stated.*

**DISTRIBUTION POLICY** *It is the firm policy of DELANY PRODUCTS to sell to plumbing wholesalers only. We regret that orders cannot be accepted from contractors or end users.*

**GENUINE DELANY PARTS** *Manufactured to the same exacting standards as our original equipment, genuine Delany renewal parts are assurance of additional years of faultless service. The wavy line logo in the box above identifies genuine parts as unmistakably Delany and unmistakably correct.*

**OMISSION ALLOWANCES** *If assemblies are ordered less one or more parts, deduct from price of the assembly  $\frac{1}{3}$  of the price of each part omitted.*

**SCALE** *Drawings on the following pages do not illustrate the actual physical size of Delany parts. In the interest of clarity, scale may vary from drawing to drawing.*

**FINISHES** — *Descriptions and prices are for polished chrome where material is for exposed use and for rough brass where material is normally concealed. Certain parts are common to both exposed and concealed valve models and such parts are described and priced in polished chrome. If rough brass finish is desired, so specify and deduct 10% from price shown for polished chrome. If satin chrome, satin brass, or polished brass finish is desired, so specify and add 225% to polished chrome price.*

# DELANY PRODUCTS

CHARLOTTESVILLE, VIRGINIA 22902, U.S.A.

(434) 296-0166 / Fax (434) 977-3596

# Delany Control Stops

## Genuine Renewal Parts

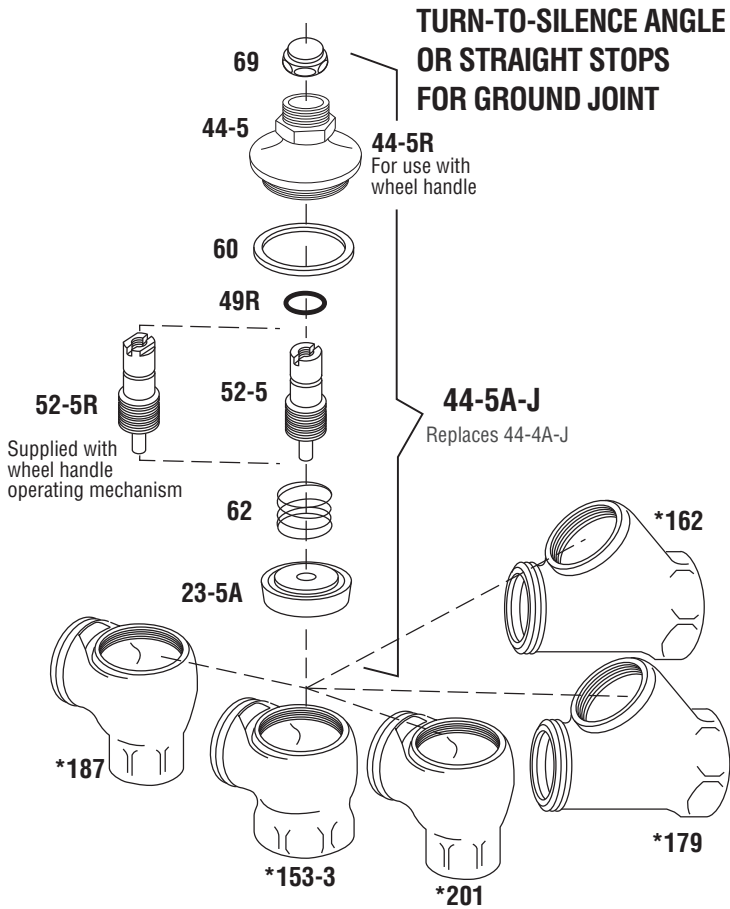

### \*TO SPECIFY COMPLETE STOPS

Add suffix "A" to appropriate body number. Then add appropriate letter for required operating mechanism.

Example:

156 1" Angle Control Stop SlipFit Connection - Body Only

156A-J 1" Angle Stop Complete, SlipFit Connection, screwdriver operated w/ Vandal Resistant Cap

Variation letters for other types of operating mechanisms are shown in the Operating Mechanism Variations chart.

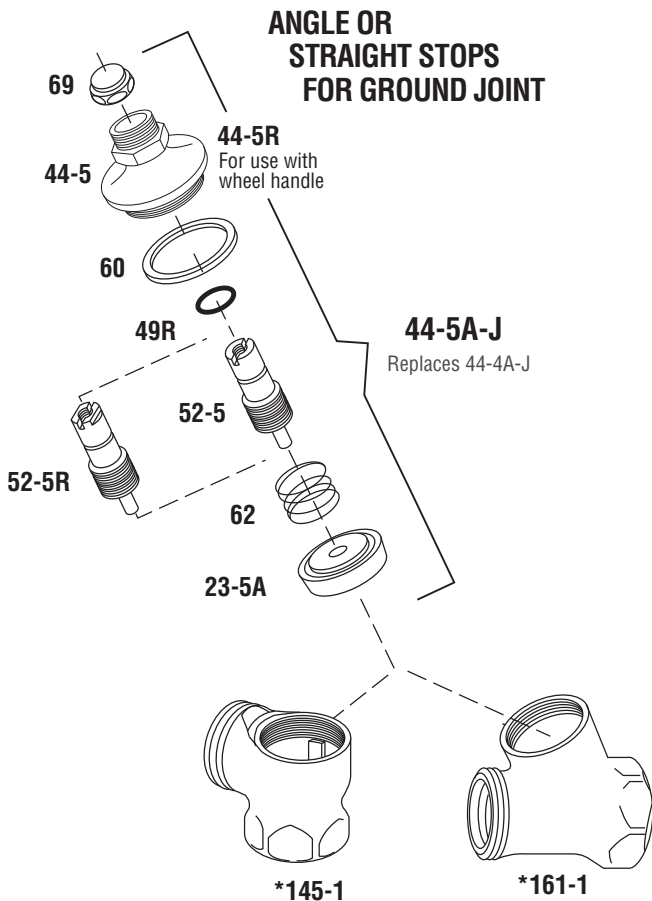

### 1" & 3/4" ANGLE STOPS FOR SLIPFIT OUTLET

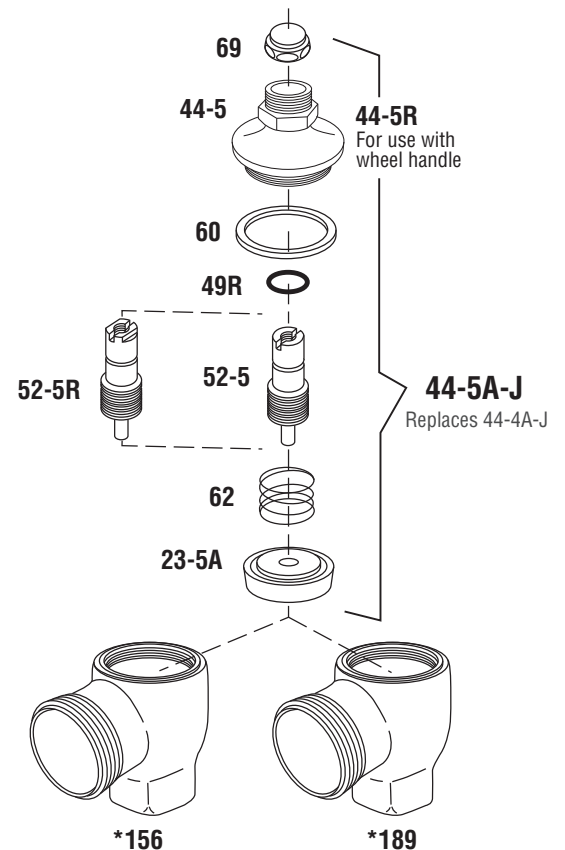

# OPERATING MECHANISM VARIATIONS

**Delany Control Stops**  
Genuine Renewal Parts

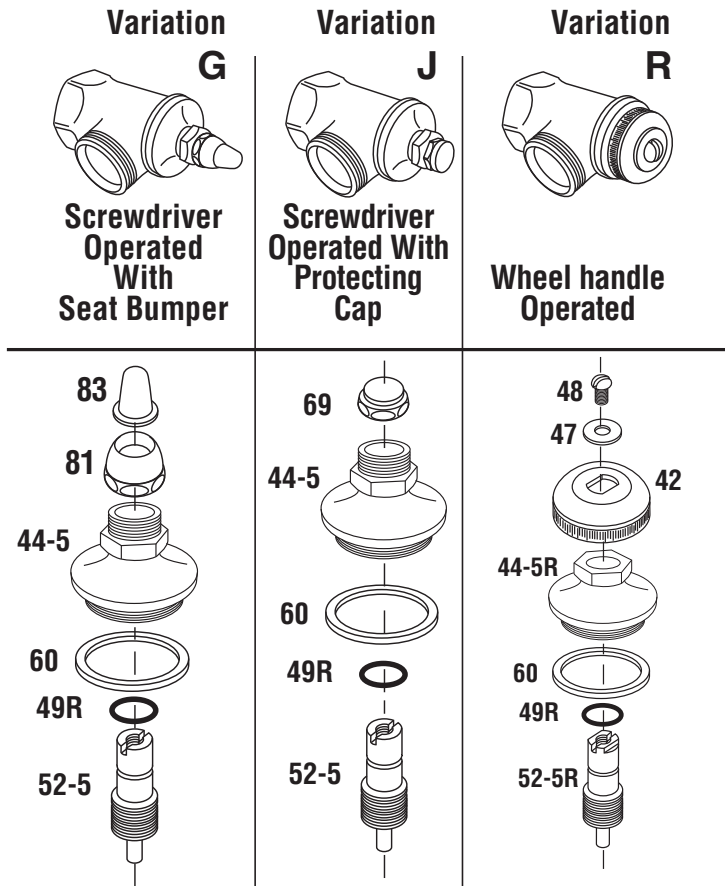

- Type of operating mechanism must be specified for complete stops or bonnet assemblies. Select appropriate variation letter from chart above and suffix to assembly number. For example: 44-5A-J, 44-5A-G, etc. Choice of operating mechanisms does not change price of complete stops or partial assemblies above.

## Control Stops Complete

Sizes refer to inlets. All outlets are 1" union connections

▪ 145A	1 1/4" Angle stop for ground joint
▪ 153-3A	1" Turn-to-Silence angle stop for ground joint
▪ 156A	1" Turn-to-Silence angle stop for SlipFit connection
▪ 161A	1 1/4" Straight stop for ground joint
▪ 162A	1" Turn-to-Silence straight stop for ground joint
▪ 179A	3/4" Turn-to-Silence straight stop for ground joint
▪ 187A	3/4" Turn-to-Silence angle stop for ground joint
▪ 189A	3/4" Turn-to-Silence angle stop for SlipFit connection

## Partial Assemblies

▪ 44-5A	Bonnet assembly complete (for Turn-to-Silence stops)
---------	--

## Individual Parts Listing

Sizes refer to inlets. All outlets are 1" union connections except on rigid stops

23-5A	Disc with metal insert (for Turn-to-Silence stops)
42	Wheel handle
44-5	Bonnet (for Turn-to-Silence stops)
47	Washer for wheel handle
48	Screw for wheel handle
49R	Packing for shut off stem
52-5	Shut off stem (for Turn-to-Silence stops)
52-5R	Shut off stem (for Turn-to-Silence stops)
60	Bonnet washer
62	Back check spring
69	Protecting cap
81	Bumper holder
83	Seat bumper
145-1	1 1/4" angle stop body only
153-3	1" Turn-to-Silence angle stop body only
161-1	1 1/4" straight stop body only
162	1" Turn-to-Silence straight stop body only
179	3/4" Turn-to-Silence straight stop body only
187	3/4" Turn-to-Silence angle stop body only
189	3/4" angle stop body only (with sweat inlet)

# Delany No. 50 Vacuum Breaker

## Genuine Renewal Parts

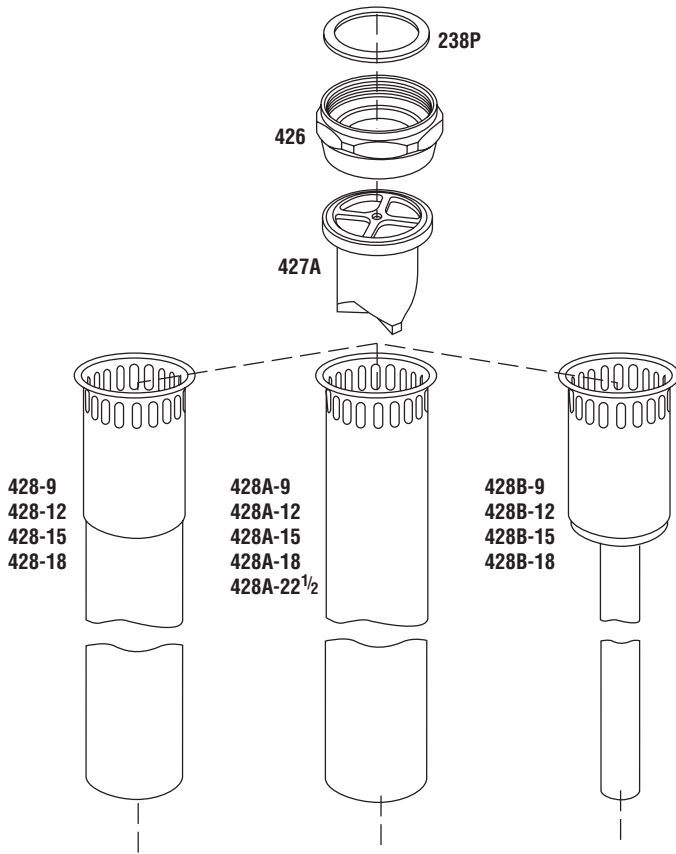

### Individual Parts

238P	Coupling washer
426	Cowl nut
427A	Rubber sleeve with metal insert
428-9	Vented flush connection, 1 1/2" x 1 1/4" x 9"
428-12	Vented flush connection, 1 1/2" x 1 1/4" x 12"
428-15	Vented flush connection, 1 1/2" x 1 1/4" x 15"
428-18	Vented flush connection, 1 1/2" x 1 1/4" x 18"
428-22 1/2	Vented flush connection, 1 1/2" x 1 1/4" x 22 1/2"
428A-9	Vented flush connection, 1 1/2" x 1 1/2" x 9"
428A-12	Vented flush connection, 1 1/2" x 1 1/2" x 12"
428A-15	Vented flush connection, 1 1/2" x 1 1/2" x 15"
428A-18	Vented flush connection, 1 1/2" x 1 1/2" x 18"
428A-22 1/2	Vented flush connection, 1 1/2" x 1 1/2" x 22 1/2"
428B-9	Vented flush connection, 1 1/2" x 3/4" x 9"
428B-12	Vented flush connection, 1 1/2" x 3/4" x 12"
428B-15	Vented flush connection, 1 1/2" x 3/4" x 15"
428B-18	Vented flush connection, 1 1/2" x 3/4" x 18"
428B-22 1/2	Vented flush connection, 1 1/2" x 3/4" x 22 1/2"

## Delany Flanges, Nuts and Flush Connectors

Coupling Nuts		
373	3/4" x 3/4"	Coupling nut with No. 374 rubber washer (for Delany 472 valve only)
383A	1 1/4" x 1 1/4"	Coupling nut with No. 382P plastic washer
385	1 1/2" x 1 1/4"	Coupling nut with No. 238P washer
388A	1 1/2" X 1 1/2"	Coupling nut with No. 238P washer
Spud Nuts		
375A	3/4"	Spud nut with No. 376 rubber washer
381A	1 1/4"	Spud nut with No. 382P plastic washer
386A	1 1/2"	Spud nut with No. 387P plastic washer
Spud Flanges		
302-1	3/4"	Spud flange, sure grip
307-1	1 1/4"	Spud flange, sure grip
306	1 1/2"	Spud flange
Wall Flanges		
300-1	1/2"	Wall flange, sure grip (slips 1/2" IPS)
301-1	3/4"	Wall flange, sure grip (slips 3/4" IPS)
313	3/4"	Cast wall flange with No. 340 allen head set screw (slips covering tube for 3/4" sweat stop)
313S	3/4"	Wall flange, sure grip (slips covering tube for 3/4" sweat stop)
303-1	1"	Wall flange, sure grip (slips 1" IPS)
314	1"	Cast wall flange with No. 340 allen head set screw (slips covering tube for 1" sweat stop)
314S	1"	Wall flange, sure grip (slips covering tube for 1" sweat shop)

### Wall Flanges (continued)

304-1	1 1/4"	Wall flange, sure grip (slips 1 1/4" IPS)
Covering Tubes		
316		Covering tube 2" long (for 3/4" sweat stop)
315		Covering tube 4" long (for 1" sweat stop)
Flush Connections		
248	3/4" x 9"	Straight flush connection, threaded one end
251	3/4" x 9"	Straight flush connection with cast collar
250	1 1/2" x 9"	Straight flush connection with flanged collar
336A	1/14" x 5"	Flush elbow with one slip nut and washer
338A	1 1/2" x 5"	Flush elbow with one slip nut and washer
Conc. Flush Elbow Connections		
‡450A	3/4"	Flush elbow, scored one end, with one slip nut and washer (for concealed valve)
‡447A	1 1/4"	Flush elbow, scored one end, with one slip nut and washer (for concealed valve)
‡445A	1 1/2"	Flush elbow, scored one end, with one slip nut and washer (for concealed valve)

‡ For 1" wall thickness (actual length from centerline of elbow to end 4 3/4" for 3/4" elbow, 4 1/2" for 1 1/4" elbow, 4 5/8" for 1 1/2" elbow).