

# Flushboy Parts Breakdown

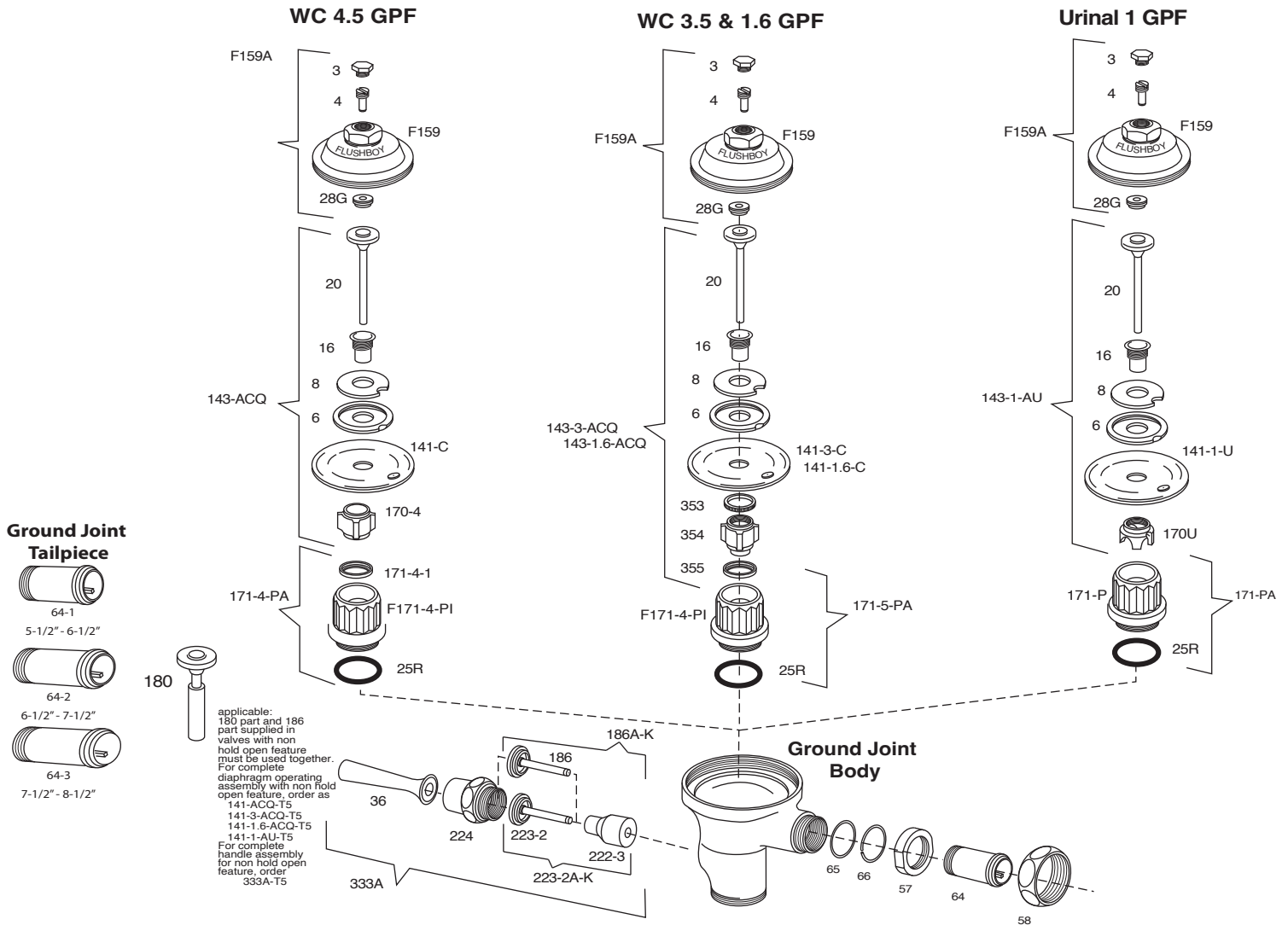

Assemblies	
141-1.6-KC	Diaphragm Repair Kit (1.6 GPF)
141-3-KC	Diaphragm Repair Kit (3.5 GPF)
141-KC	Diaphragm Repair Kit (4.5 GPF)
143-1.6-ACQ	Diaphragm Drop-in Kit (1.6 GPF)
143-3-ACQ	Diaphragm Drop-in Kit (3.5 GPF)
143-ACQ	Diaphragm Drop-in Kit (4.5 GPF)
186A-K	Internal Handle Assembly of Non Hold Open ONLY (1-13/16" Length)
223-2A-K	Internal Handle Assembly (1-7/8" Overall Length)
333A	Full Handle Assembly
153-3A-J	1" Ground Joint Angle Control Stop (Not Pictured)
187A-J	3/4" Ground Joint Angle Control Stop (Not Pictured)
F159-A	Flushboy Cover Assembly
171-4-PA	Main Valve Seat Assembly for 4.5 GPF ONLY
171-5-PA	Main Valve Seat Assembly for ALL Other Valves except 4.5 GPF
171-PA	Main Valve Seat Assembly for Urinals

\*\*Note: Shaded Areas Represent Purchaseable Items

Individual Parts			
3	Cover Screw	224	Handle Nut
4	Regulating Screw	353	Refill Ring
6	Relief Rod Seat Holder	354	Main Valve Seat Guide
8	Relief Rod Seat Washer	355	Choke Ring for Main Valve Seat
20	Relief Rod	36	Handle
28G	Packing for Covers (Sold 10 per bag)	F171-4-PI	Main Valve Seat WC (White)
57	Clamping Nut for GJ Tailpiece to Stop	170-P	Main Valve Seat Urinal (Grey)
58	Union Nut for GJ Tailpiece to Stop	170-U	Urinal Seat Guide
64	Adjustable Ground Joint Tailpiece	25R	Main Valve Seat Washer
65	O-Ring for Tailpiece to Stop	141-C	Diaphragm (4.5 GPF)
66	Clamping Ring for GJ Tailpiece to Stop	141-3-C	Diaphragm (3.5 GPF)
180	Relief Rod for Non Hold Open valves ONLY	141-1.6-C	Diaphragm (1.6 GPF)
186	Operating Stem of Non Hold Open ONLY (1-13/16" Overall Length)	141-1-U	Diaphragm (1 GPF)
222-3	Rubberflexer	64-1	Ground Joint Tailpiece (5-1/2" to 6-1/2")
223-2	Operating Stem (1-7/8" Overall Length)	64-2	Ground Joint Tailpiece (6-1/2" to 7-1/2")
		64-3	Ground Joint Tailpiece (7-1/2" to 8-1/2")